

LUXOMAT® Indoor 180-R and Indoor 180-T



With acoustic-sensor



European version



UK version

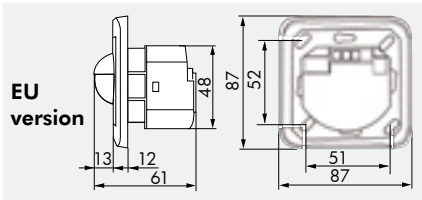

EU version

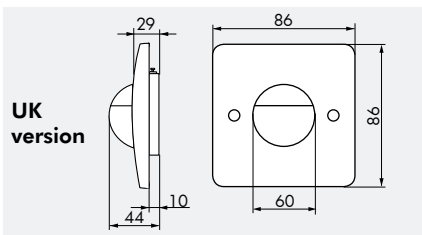

UK version

TECHNICAL DATA

- 230V~ ±10%
- 180°
- max. 10.00 m
- IP20 / Class II / C€
- European version**
L87 x W87 x D61 mm
- UK version**
L86 x W86 x D44 mm
- 25°C to +50°C
- UV- and shock-resistant Polycarbonate
- 180-R**
2300 W, cosφ = 1;
- 180-T**
max. 300 W / min. 40 W
- 15 sec. - 16 min. or impulse
- 5 - 2000 Lux

! The microphone in the Indoor 180-R and 180-T is only active after detection of motion!

PRODUCT INFORMATION

- Combined motion detector and acoustic sensor as wall switch LUXOMAT® Indoor 180-R/-T-FM with 180° detection area
- **European version:** combinable with coverings in five different colours
- **European version:** for the combination with switches of leading manufacturers the enclosed additional intermediate frame can be used
- Version IP20 and IP54 (only European version – for moisture-proofs, garages, cellar steps)
- Light sensor, acoustic sensitivity and follow-up time are adjustable
- Installation either at the side of the door or above in a fixing height between 1.10 m and 2.20 m
- **180-R:** relay version in 3-conductor or in 2-conductor (only UK version) engineering for inductive, capacitive and ohmic loads
- **180-T:** triac version in 2-conductor engineering, without neutral conductor, for operation of incandescent lamps up to 300 W
- The detection area can be altered by using the included blinds at the bottom of the detector
- **European version:** surface mount installation is possible with accessory SM-socket (92141)
- **Application examples:** monitoring of public lavatories, corridors, archive rooms, conference rooms etc.
- **Coverings please order separately!**

ACCESSORY (OPTIONAL)

Covering IP20



pure white, RAL9010



traffic white, RAL9016



cream white, RAL1013



anthracite, RAL7021



silver, RAL9006

Covering IP54

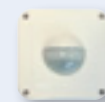

pure white, RAL9010

SM-Socket



pure white, RAL9010

Blinds



Description	Colour	Part number
Indoor 180-R, fully fitted (European version)	pure white, RAL9010	92623
Indoor 180-T, fully fitted (European version)	pure white, RAL9010	92622
Indoor 180-R, fully fitted (UK version)	pure white, RAL9010	92610
Sensor insert for Indoor 180-R-FM (European version)	–	92665
Sensor insert for Indoor 180-T-FM (European version)	–	92664
Accessory for sensor insert		
Covering IP20	pure white, RAL9010	92630
Covering IP20	traffic white, RAL9016	92631
Covering IP20	cream white, RAL1013	92632
Covering IP20	silver, RAL9006	92633
Covering IP20	anthracite, RAL7021	92634
Covering IP54	pure white, RAL9010	92139
Accessory (optional)		
SM-Socket for Indoor	pure white, RAL9010	92141

